

# LegalTech

## February 3 - 5, 2015

### THE NEW YORK HILTON & TOWERS

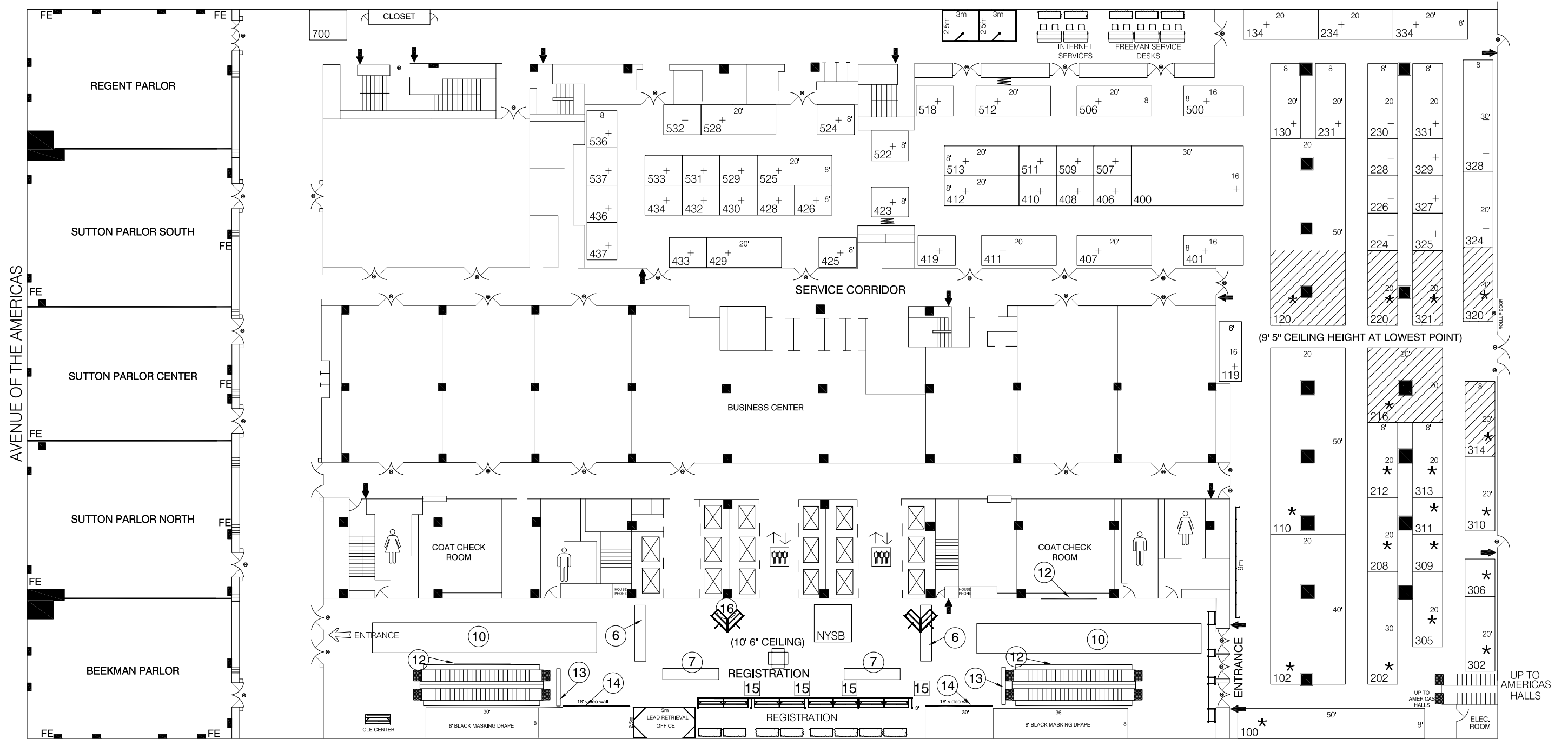

ALL BOOTHS ARE 8' x 10', UNLESS NOTED OTHERWISE.  
 ▨ INDICATES LATE SETUP/EARLY DISMANTLE  
 + Premium Booths  
 ★ Platinum Booths

#### 54th STREET LAYOUT LEGEND

- 1 - ATTENDEE REGISTRATION
- 2 - EXHIBITOR REGISTRATION
- 3 - LEAD RETRIEVAL
- 4 - ALM CORPORATE BOOTH
- 5 - FREEMAN SERVICE DESKS
- 6 - 2 SIDE BANNER HUNG FROM TRACKING (15' x 3' Max)
- 7 - 2 SIDED BANNER IN CUT OUTS (15' x 3' Max)
- 8 - FILL IN COUNTER
- 9 - ALM AFFILIATES
- 10 - FLOOR LOGOS
- 11 - PUBLICATION BINS
- 12 - 1 SIDED BANNER (15' x 8' Max)
- 13 - FLOOR LOGO MATERIAL ATTACHED TO METAL (10' x 1' Max)
- 14 - 10' x 8'
- 15 - 4' x 4' FLOOR LOGOS
- 16 - SPEED BADGE COUNTERS

← FIRE ALARMS MUST BE VISIBLE AT ALL TIMES.  
 • INDICATED FIRE EXITS  
 FE - FIRE EXTINGUISHER

UP TO AMERICAS HALLS

# LegalTech February 3 - 5, 2015 THE NEW YORK HILTON & TOWERS

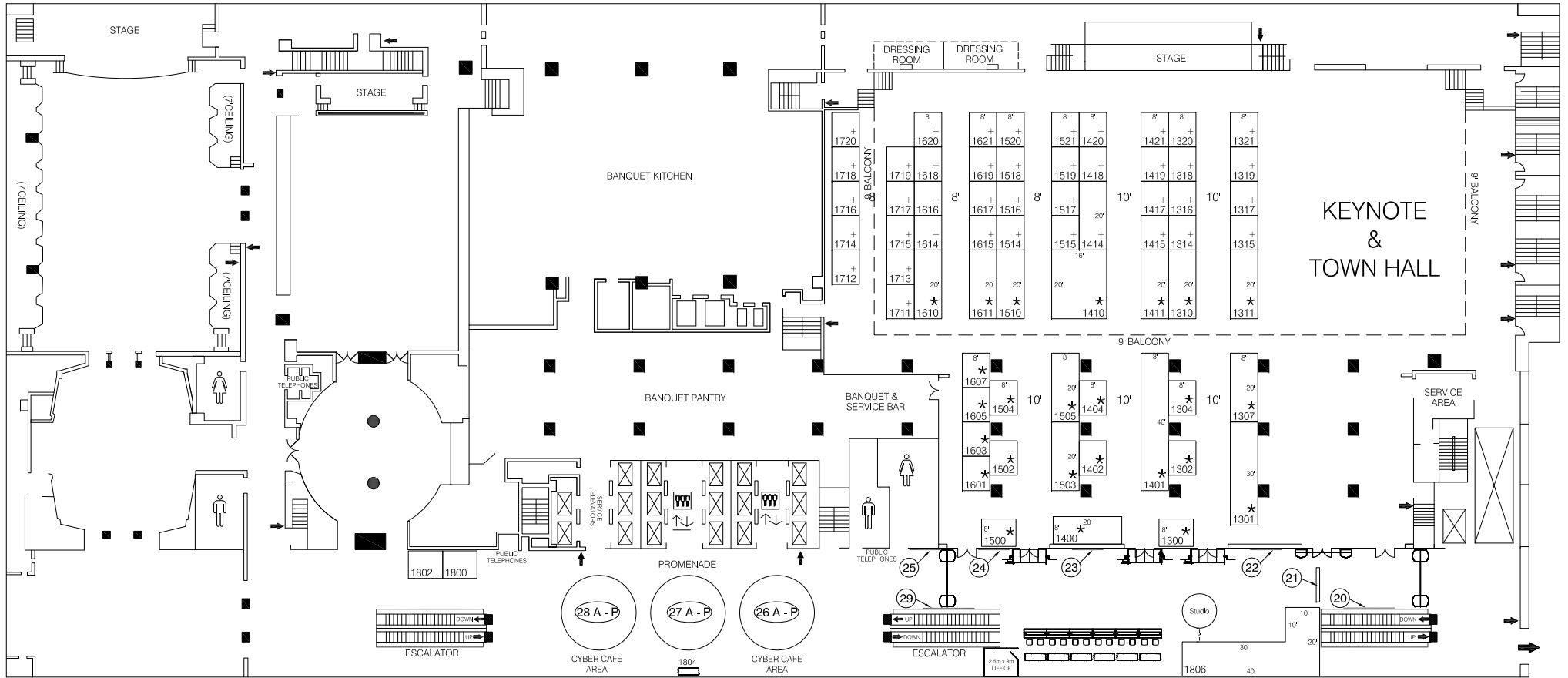

← FIRE ALARMS MUST BE VISIBLE AT ALL TIMES.

ALL BOOTHS ARE 8' x 10', UNLESS NOTED OTHERWISE.

▨ INDICATES LATE SETUP/EARLY DISMANTLE

+ Premium Booths

\* Platinum Booths

54th STREET

### LAYOUT LEGEND

- 20 - 8' x 20' BANNER
- 21 - 3' x 15' D/S BANNER
- 22 - 8' x 10' BANNER
- 23 - 8' x 20' BANNER
- 24 - 8' x 10' BANNER
- 25 - 8' x 10' BANNER
- 26 A-P 2' x 4' WINDOW DECALS  
(16 spots around glass)
- 27 A-P 2' x 4' WINDOW DECALS  
(16 spots around glass)
- 28 A-P 2' x 4' WINDOW DECALS  
(16 spots around glass)
- 29 - 8' x 20' BANNER

# LegalTech

## February 3 - 5, 2015

### THE NEW YORK HILTON & TOWERS

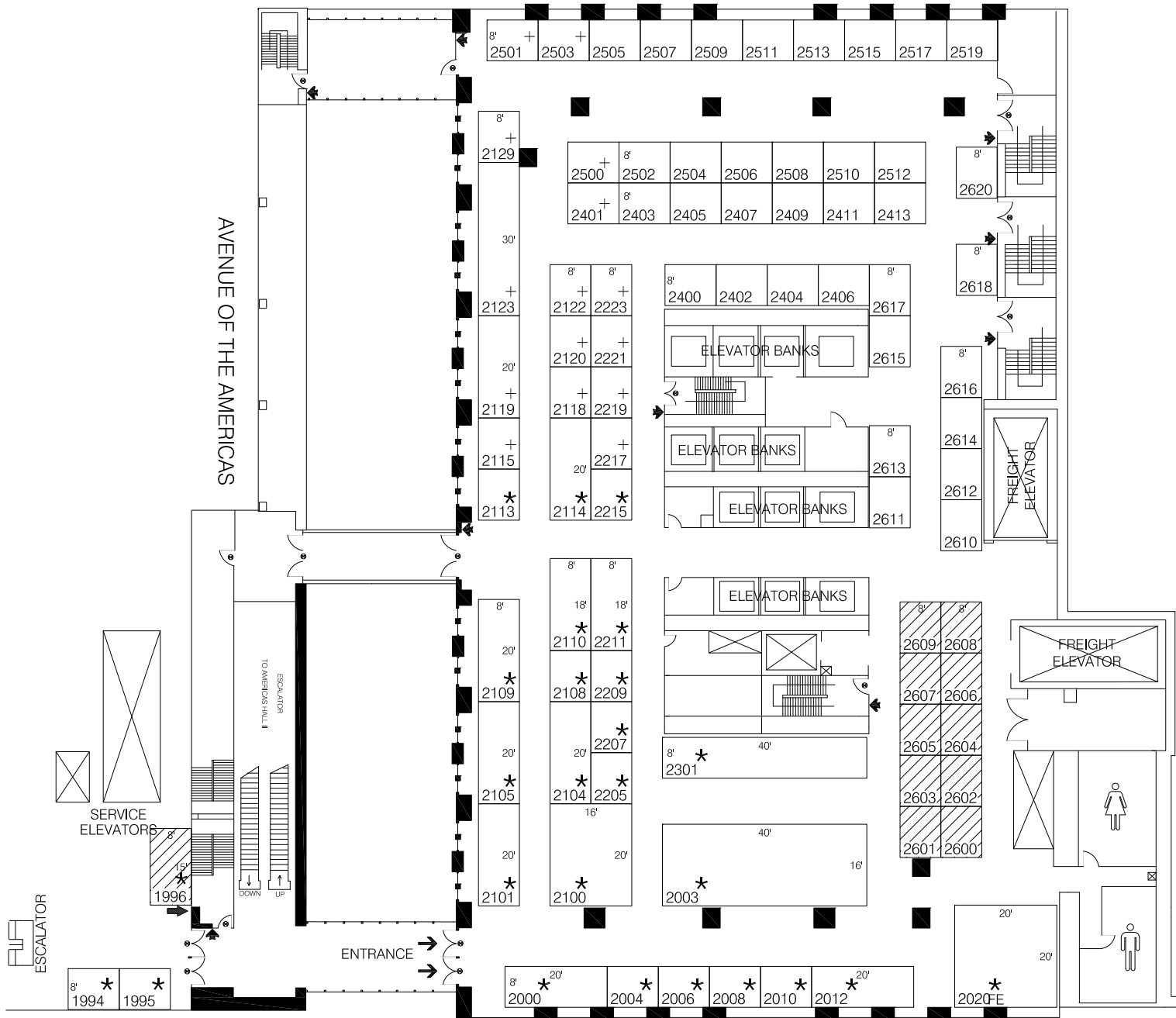

← INDICATED FIRE ALARMS  
 • INDICATED FIRE EXITS

54th STREET

ALL BOOTHS ARE 8' x 10', UNLESS NOTED OTHERWISE.

▨ INDICATES LATE SETUP/EARLY DISMANTLE

+ Premium Booths

\* Platinum Booths